

For Lease

📍 16288 Boyle Avenue | Fontana, CA

±87,444 SF



Property Highlights

- » ±87,444 Square foot concrete tilt-up
- » ±3,000 SF office space and ±3,000 SF mezzanine
- » LEED Certified Silver
- » 32' Clearance height
- » 132' Truck Court
- » 2.5% Skylights
- » ESFR sprinkler system K-17 @52PSI
- » Twelve (12) 9' x 10' dock high doors
- » One (1) 12' x 14' grade level door
- » 2,000 Amps power
- » LED site lighting
- » 49 Auto stalls
- » Three (3) 12' x 52' trailer stalls
- » Three (3) trailer stalls
- » Floor slab 6" thick, 4000 PSI
- » White foil-backed scrim across warehouse roof



CLICK TO VIEW
VIRTUAL TOUR

For more information,
please contact:

Brad Yates, SIOR®

brad.yates@streamrealty.com

T 909.970.6204

Lic. 01708615

Stefan Pastor, SIOR®

stefan.pastor@streamrealty.com

T 909.970.6203

Lic. 01903973

For Lease

±87,444 SF

📍 16288 Boyle Avenue | Fontana, CA

Aerial Map

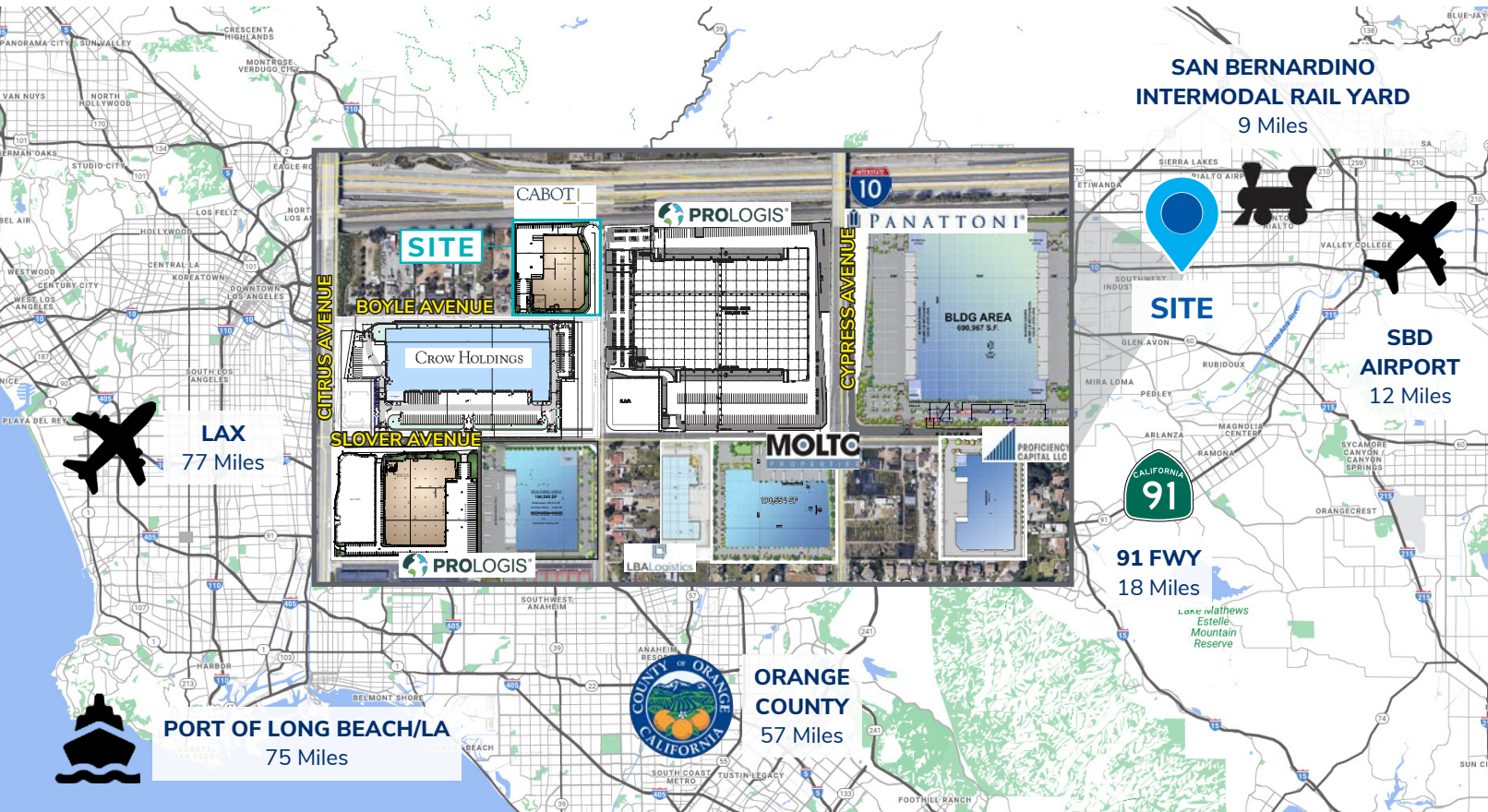

For more information, please contact:

Brad Yates, SIOR®

brad.yates@streamrealty.com

T 909.970.6204

Lic. 01708615

Stefan Pastor, SIOR®

stefan.pastor@streamrealty.com

T 909.970.6203

Lic. 01903973

Copyright © 2023 Stream Realty Partners. All rights reserved. The information contained herein was obtained from sources believed reliable; however, Stream Realty Partners, L.P. make no guarantees, warranties or representations as to the completeness or accuracy thereof. The presentation of this property is submitted subject to errors, change of price, or conditions, prior sale or lease, or withdrawal without notice.

For Lease

±87,444 SF

16288 Boyle Avenue | Fontana, CA

Site Plan

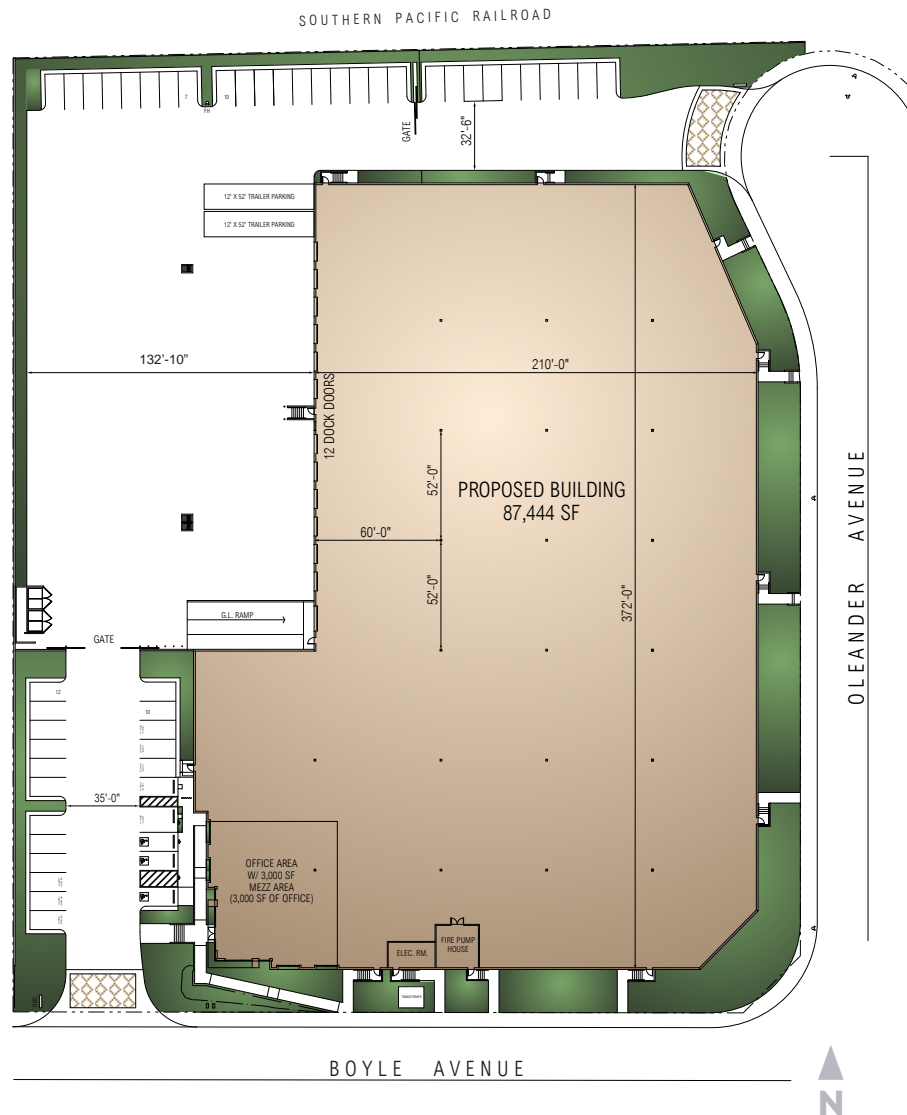

Brad Yates, SIOR®

brad.yates@streamrealty.com

T 909.970.6204

Lic. 01708615

Stefan Pastor, SIOR®

stefan.pastor@streamrealty.com

T 909.970.6203

Lic. 01903973

Copyright © 2023 Stream Realty Partners. All rights reserved. The information contained herein was obtained from sources believed reliable; however, Stream Realty Partners, L.P. make no guarantees, warranties or representations as to the completeness or accuracy thereof. The presentation of this property is submitted subject to errors, change of price, or conditions, prior sale or lease, or withdrawal without notice.

For Lease

±87,444 SF

📍 16288 Boyle Avenue | Fontana, CA

Corporate Neighbors

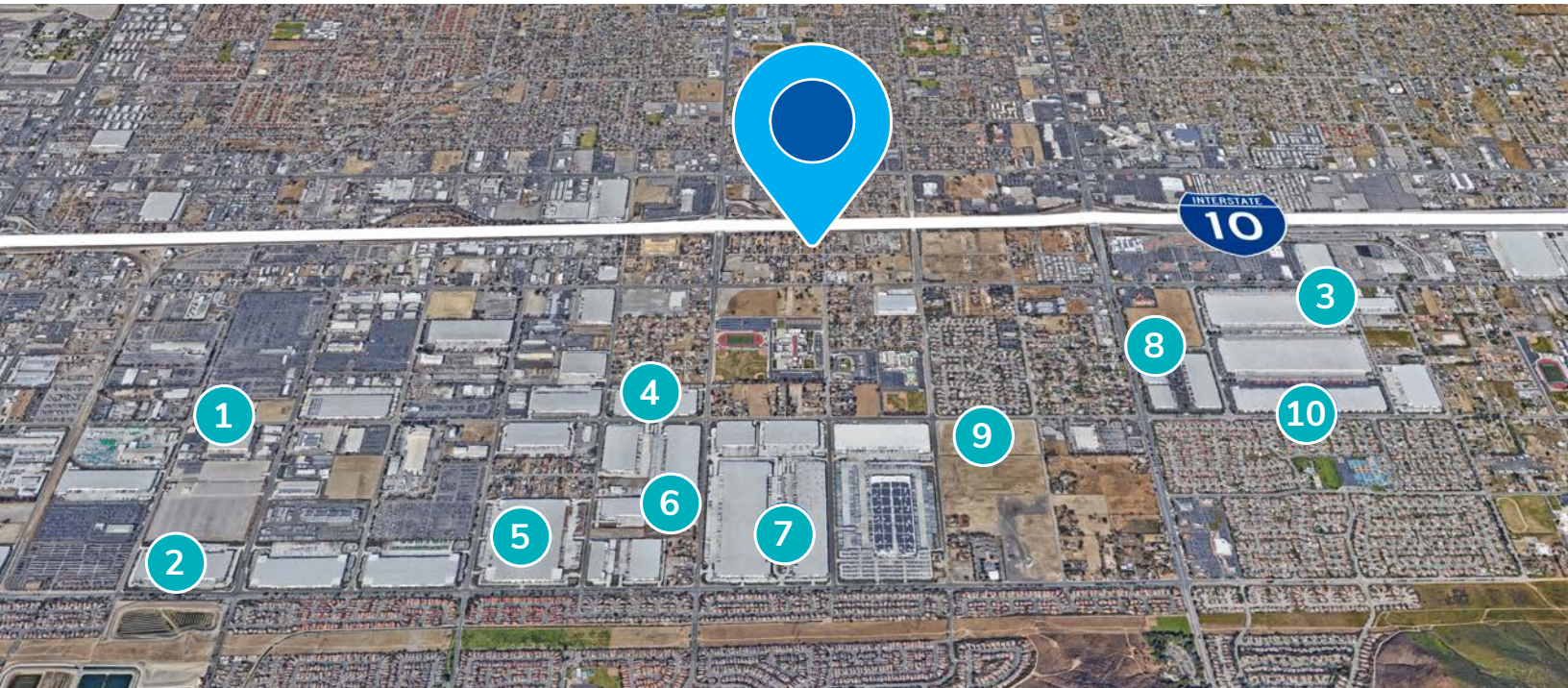

For more information,
please contact:

Brad Yates, SIOR®
brad.yates@streamrealty.com
T 909.970.6204
Lic. 01708615

Stefan Pastor, SIOR®
stefan.pastor@streamrealty.com
T 909.970.6203
Lic. 01903973

Copyright © 2023 Stream Realty Partners. All rights reserved. The information contained herein was obtained from sources believed reliable; however, Stream Realty Partners, L.P. make no guarantees, warranties or representations as to the completeness or accuracy thereof. The presentation of this property is submitted subject to errors, change of price, or conditions, prior sale or lease, or withdrawal without notice.

For Lease

±87,444 SF

📍 16288 Boyle Avenue | Fontana, CA

New Developments

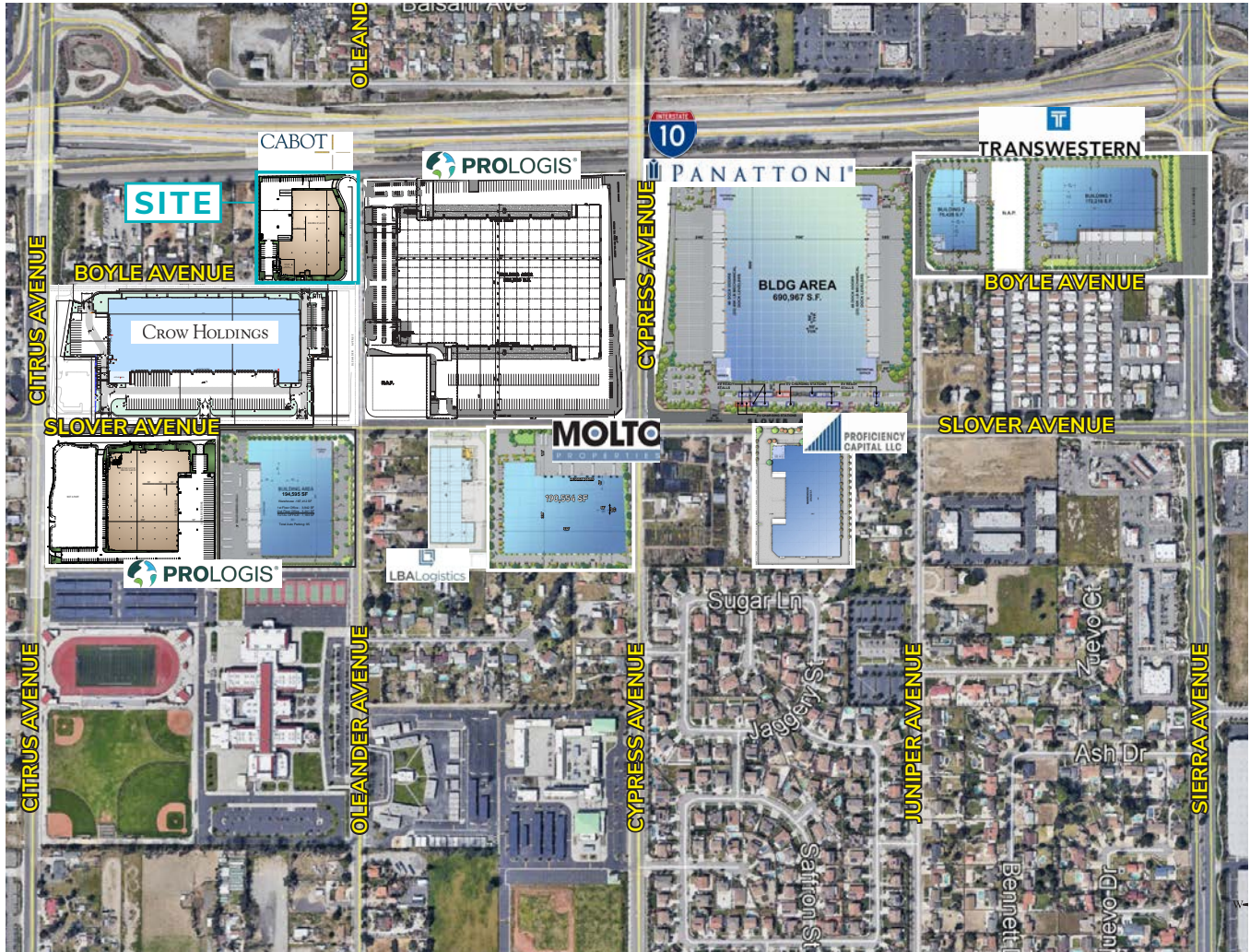

Brad Yates, SIOR®

brad.yates@streamrealty.com

T 909.970.6204

Lic. 01708615

Stefan Pastor, SIOR®

stefan.pastor@streamrealty.com

T 909.970.6203

Lic. 01903973

Copyright © 2023 Stream Realty Partners. All rights reserved. The information contained herein was obtained from sources believed reliable; however, Stream Realty Partners, L.P. make no guarantees, warranties or representations as to the completeness or accuracy thereof. The presentation of this property is submitted subject to errors, change of price, or conditions, prior sale or lease, or withdrawal without notice.